

Data Sheet 34

Chain Conveyor RL & RM

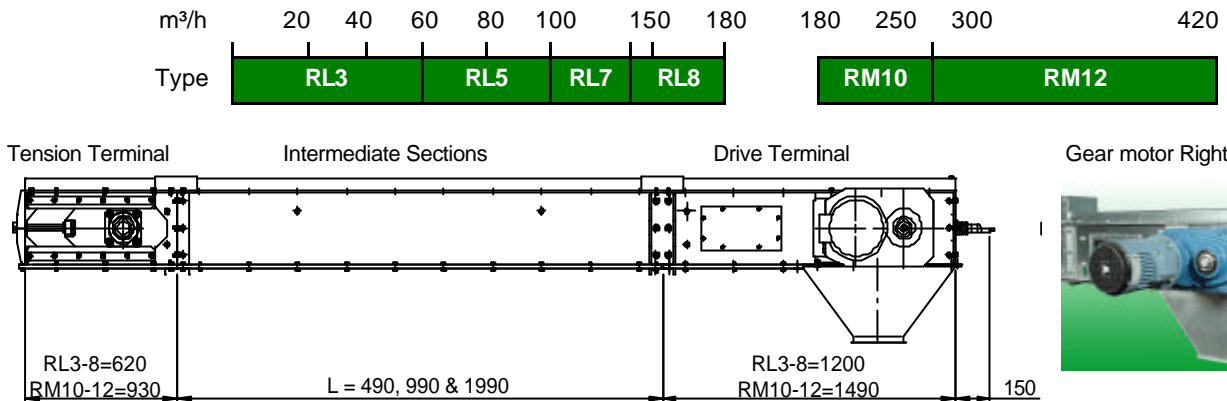

Cimbria chain Conveyor are manufactured in 8 different sizes with capacities ranging from 45 to 830 MT of wheat per hour (specific gravity 0.76 dry and cleaned) at a chain speed of 0.5 m/s.



Cimbria chain conveyors are supplied in easily assemble modular sections, in galvanised plate, alternatively a painted finish can be supplied for types RL/RM 3-12, or hot dip galvanised for types RL 14-16. The conveyors are also available with a wide range of accessories.

Tension Terminal:

The sprocket wheel is mounted with ball bearings in a saddle plate so that tightening of the chain can be easily done even during operation.



Drive Terminal (see data sheet 34.1):

Right mounted hollow shaft gearbox is standard. Direct mounted gear motor can be supplied upon request. Sensor mounted as an overflow control. Outlet spout with a Q-flange. The drive terminal is prepared for an inspection window.

Chain (see data sheet 34.1):

The conveyor chain is manufactured from special steel with welded flights, and is fitted with hardened steel bushes. Integrated plastic flaps for emptying. The chain can be with or without return buckets

Intermediate Section:

10 mm PEHD wearplate on the bottom ensures a low level of noise and wear.

The chain conveyor is joined with fish plates to ensure a tight and flush fitting internal wall.

Dual Sided Inlet (see data sheet 34.3):

Trough for intake chain conveyors with a stable cover over the return chain, and side inlet.

Intermediate Bottom and raised Lid (see data sheet 34.3):

The conveyors can be supplied with an intermediate bottom. This makes virtually any configuration of outlets possible.

Outlets and Shutters (see data sheet 34.2):

The chain conveyors can be fitted with a number of outlets, which are fitted with shutters, which can be controlled by any of the following:

- ✗ Manual
- ✗ Pneumatic
- ✗ Spindle Motor



Accessories:

Shutters are supplied with free hanging brushes cleaning the chain as standard.

		RL3	RL5	RL7	RL8	RM10	RM12	RM14*	RM16*
Chain box Height (H)	mm	360	420	475	510	625	740	920	1130
Width (B)	mm	260	310	335	405	480	600	750	930
Grain layer thickness	mm	180	240	290	330	420	530	660	850
Grain Layer Width	mm	205	255	280	330	400	500	630	800
Top Plate	mm	2	2	2	2	2.5	2.5	2.5	3
Side Plate	mm	2	2	3	3	4	4	6	6
Bottom Plate	mm	3	3	3	3	4	4	6	6
Weight Empty	kg/m	35	45	70	75	115	145	190	280
Weight Full	kg/m	70	100	140	165	255	355	520	825
Capacity by volume at (Chain Speed)**									
0.45 m/sec.	m³/h	54	90	120	158	250	386	600	970
0.50 m/sec.	m³/h	60	100	132	176	278	430	670	1080
0.60 m/sec.***	m³/h	72	120	160	210	335	515	800	1300

* RM14 and RM16 are not stocked

** In practice the chain speed will vary a few per cent due to variations of the rpm.

*** Chain speed of 0.60 m/sec. should only be used in connection with lightly flowing materials and in conveyors with an end outlet.

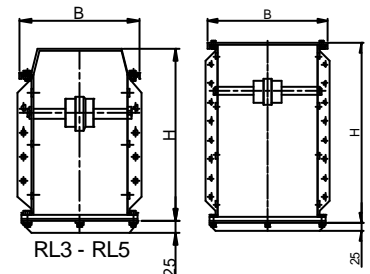

Copyright ? - The right to alterations is reserved